

# St. Annes Close

ST GEORGE

APPROXIMATE FLOOR AREA

66 SQM / 710 SQFT



1ST FLOOR

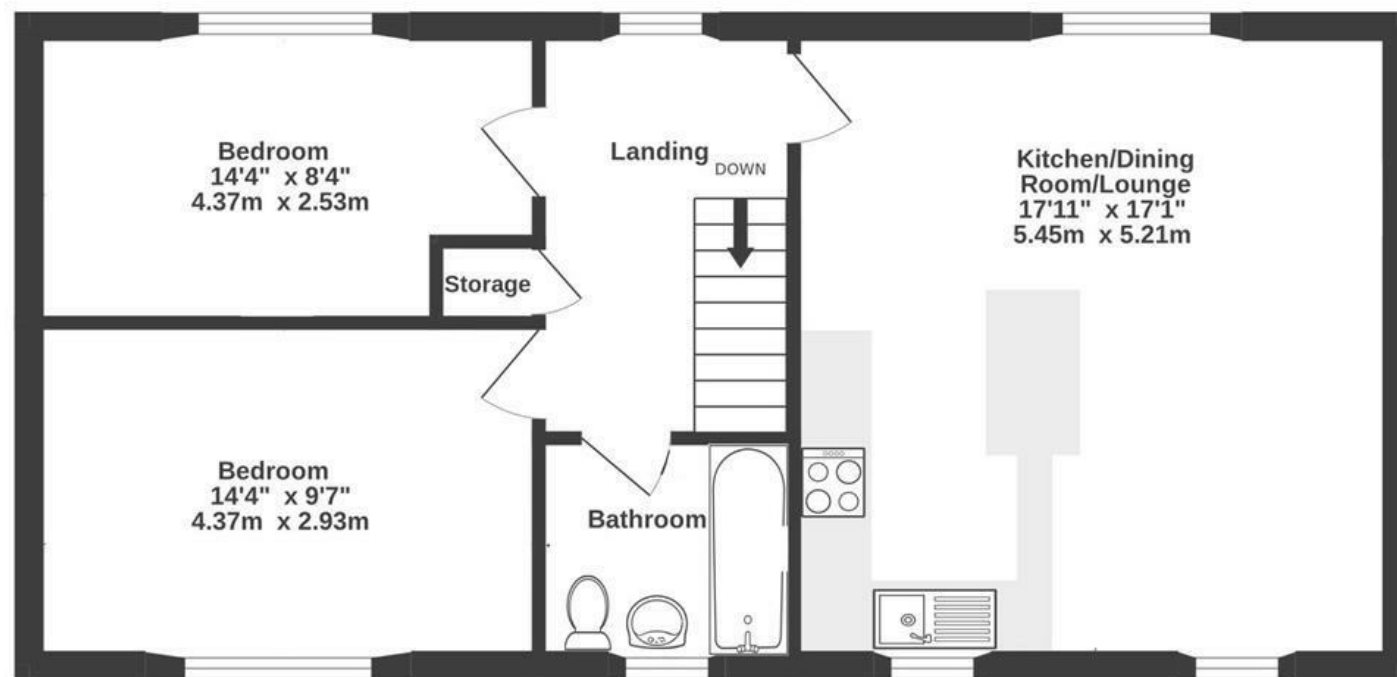

Boardwalk

# St. Annes Close

ST. GEORGE, BRISTOL



£290,000



2 Bedrooms



BS5 8DQ



1 Bathrooms

*"This has been the perfect first home for us. Crew's Hole feels like an oasis in the city – an easy cycle along the river to the centre and Temple Meads, yet surrounded by nature at Conham River Park and Dundridge Park. We've loved the peace and quiet, the airy living room filled with natural light, and evenings at Trooper's Hill watching balloons or fireworks drift across the sky"*

